

MODEL - MATE

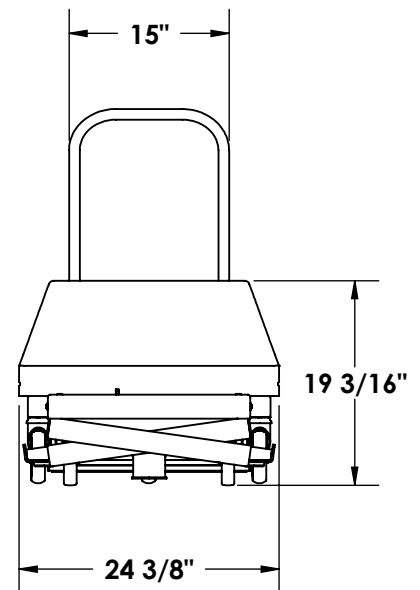
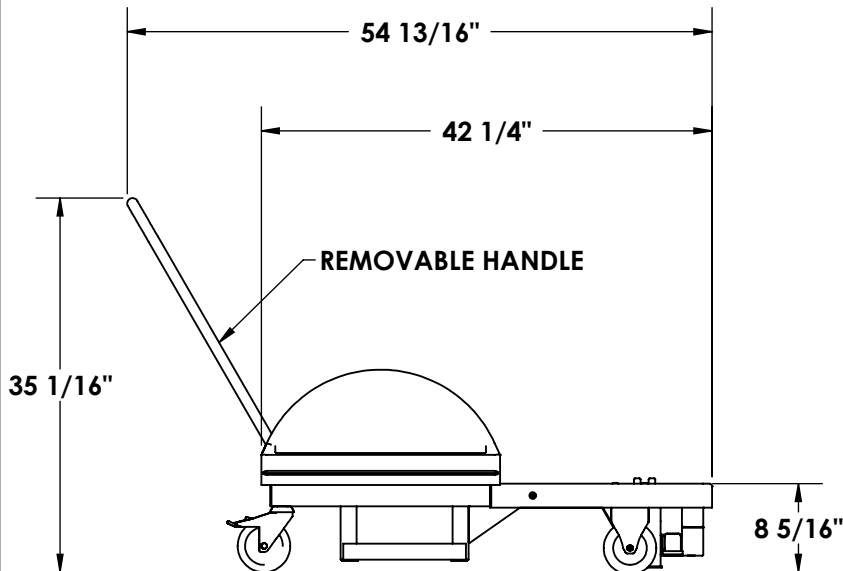
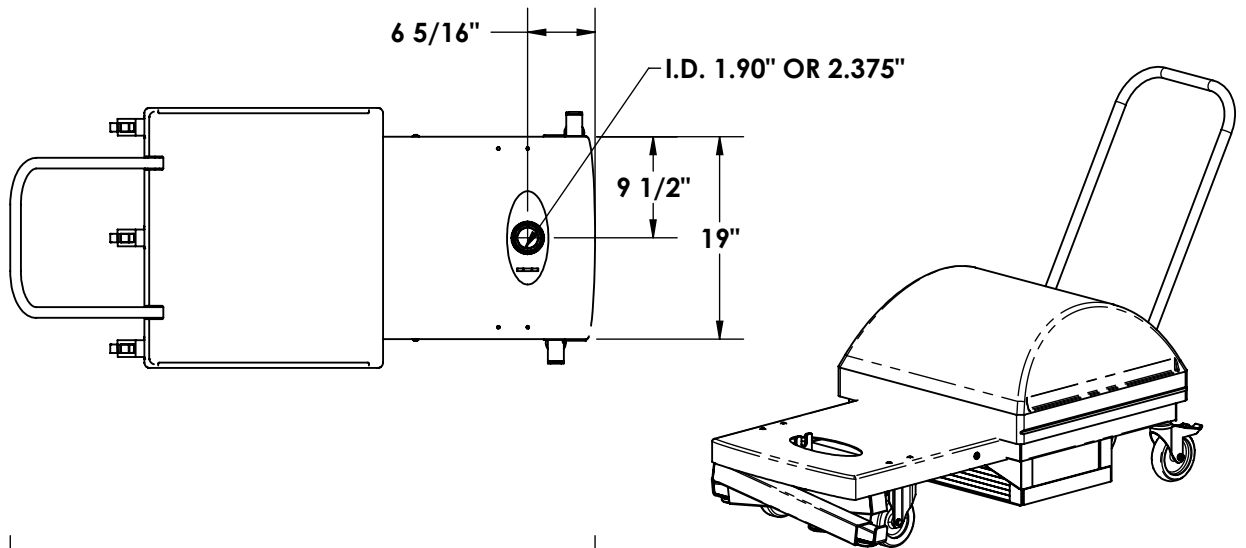

NOTE:

1 **DIMENSIONS VARY WITH SPECIFIC APPLICATIONS.
SPECIFICATIONS ARE NOMINAL AND ARE SUBJECT TO CHANGE.
PLEASE CONTACT SPECTUM PRODUCTS FOR CUSTOM APPLICATIONS.**

SPECTRUM
Products

7100 Spectrum Lane
Missoula, Montana 59808
406.542.9781 * 800.791.8056
Fax: 406.542.1158
www.spectrumproducts.com

ENGINEERING DATA

PRODUCT:	MATE
PRODUCT #:	42173
REVISION:	A
MATERIAL:	304 SERIES STAINLESS STEEL

MATE™ (Mobile Anchor Transport Evolution), part number 42173

The MATE™ shall consist of the following components:

MATE™ Superstructure

Constructed from 304 stainless steel, 2" x 2" x .120" square tubing, 3/8" 304 stainless steel plate, 12 gauge 304 stainless steel plate and 3/16" x 1 1/2" stainless steel angle. Precision joined and welded.

Wheel Assembly

There shall be three stainless steel ball bearing Tente locking casters and two Tente stainless steel fixed casters.

Stabilizer

There shall be two 1 1/2" x 1 1/2" x .120" 304 stainless steel stabilizer arms with a rubber padded foot.

Weights

1/2" mild steel plates hot dip galvanized to the specification ASTM A 385.

Handle

Constructed of 1" x .120" 304 stainless steel tubing with TIG welded 304 stainless steel stops.

Cover

MATE™ cover constructed of LDPE with permanently molded in graphics. Front cover and side panels are fabricated from Kydex thermoforming polymer.

Warranty

Two year limited warranty.



7100 Spectrum Lane ~ Missoula, Montana 59808
800.791.8056 ~ 406.542.9781
Fax: 406-542-1158
www.spectrumproducts.com