

# Treo LED Light

The Treo LED light is a 12VAC, 5 Watt LED underwater light for gunite, vinyl liner, and fiberglass pools that features outstanding illumination qualities.

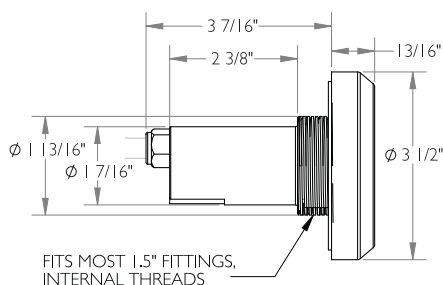

The Treo light comes with four colored trim ring options to match the surface of your pool or spa.



- Designed for use with standard thread 1.5" diameter\*
- Available in lengths of 30', 50', 80', 150'
- 50,000 hour lamp life
- No Earth bonding required
- White or color changing LED models available
- Color functions:
  - Advanced color functionality with poolLUX Premier: (49) color variations and dimming control (via wireless remote)
  - 12V controls: (6) colors (white, blue, green, red, amber, magenta) and (2) light changing shows
- Color memory function
- Four colored trim rings included to match the surface of your pool or spa
- Wide beam spread
- Synchronized operation with S.R.Smith LED lights (2014 and newer)
- Requires a minimum 2.75" of 1.5" diameter straight conduit as measured from back of wall fitting
- 3 year warranty
- ETL listed – Conforms to UL standard 676, certified to CSA C22.2 #89

| Model no.     | Description   |
|---------------|---|
| FLED-C-TR-30  | (1) 12VAC, 5W complete underwater RGB LED light assembly with 30' of low voltage cord, 4 trim rings: white, black, beige, and gray      |
| FLED-C-TR-50  | (1) 12VAC, 5W complete underwater RGB LED light assembly with 50' of low voltage cord, 4 trim rings: white, black, beige, and gray      |
| FLED-C-TR     | (1) 12VAC, 5W complete underwater RGB LED light assembly with 80' of low voltage cord, 4 trim rings: white, black, beige, and gray      |
| FLED-C-TR-150 | (1) 12VAC, 5W complete underwater RGB LED light assembly with 150' of low voltage cord, 4 trim rings: white, black, beige, and gray     |
| FLED-W-TR-30  | (1) 12VAC, 5W complete underwater white LED light assembly with 30' of low voltage cord, 4 trim rings: white, black, beige, and gray    |
| FLED-W-TR-50  | (1) 12VAC, 5W complete underwater white LED light assembly with 50' of low voltage cord, 4 trim rings: white, black, beige, and gray    |
| FLED-W-TR     | (1) 12VAC, 5W complete underwater white LED light assembly with 80' of low voltage cord, 4 trim rings: white, black, beige, and gray    |
| FLED-W-TR-150 | (1) 12VAC, 5W complete underwater white LED light assembly with 150' of low voltage cord, 4 trim rings: black, beige, and gray          |
| FLED-VK-TR    | (1) Treo Vinyl Adapter Kit, 4 colors, requires LNS-2A or similar wall fitting, allows vinyl liner to be replaced without removing light |
| FLED-LAU-C    | (1) 12VAC, 5W RGB replacement lamp for LED underwater lights  |
| FLED-LAU-W    | (1) 12VAC, 5W white replacement lamp for LED underwater lights  |
| LNS-2G        | (1) Gunite wall fitting, glues to 1.5" PVC  |
| LNS-2A        | (1) Fiberglass wall fitting, glues to 1.5" PVC  |
| LNS-2V        | (1) Vinyl wall fitting, threads to 1.5" PVC MIP   |
| FLED-C-TR-PK8 | (8) Treos (RGB) 80' <b>NEW!</b>   |
| FLED-W-TR-PK8 | (8) Treos (WHITE) 80' <b>NEW!</b>   |

\*Due to the variety and large number of manufacturers' fittings available, it may be necessary to field modify the internal shoulder if it is too shallow or too thick. This can be performed in the field in about 1-2 minutes with a 1 3/4 hole saw or small sanding drum. Installs into standard 1 1/2" wall fittings.

**Basic Requirements:** Standard 1 1/2" wall fitting with exposed face and internal threads – initially connects to 1 1/2" waterproof conduit which terminates and seals above ground.