

# STEEL CANTILEVER JUMP STAND COMPLETE MOUNTING KIT

**FIGURE A**

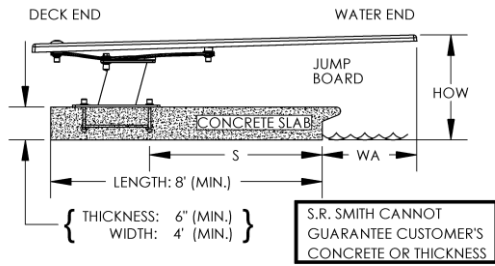

RECOMMEND COMPRESSIVE STRENGTH OF CONCRETE TO BE 3500 PSI OR GREATER

**TIGHTENING SCHEDULE**

1. SECURE STAND TO JIG WITH: ANCHOR HEX NUTS AT 40-50 FT-LBS.
2. SECURE SPRING TO STAND WITH: MOUNTING HEX NUTS AT 40-50 FT-LBS
3. SECURE BOARD TO STAND WITH: MOUNTING HEX NUTS AT 20-25 FT-LBS.

**FIGURE C**

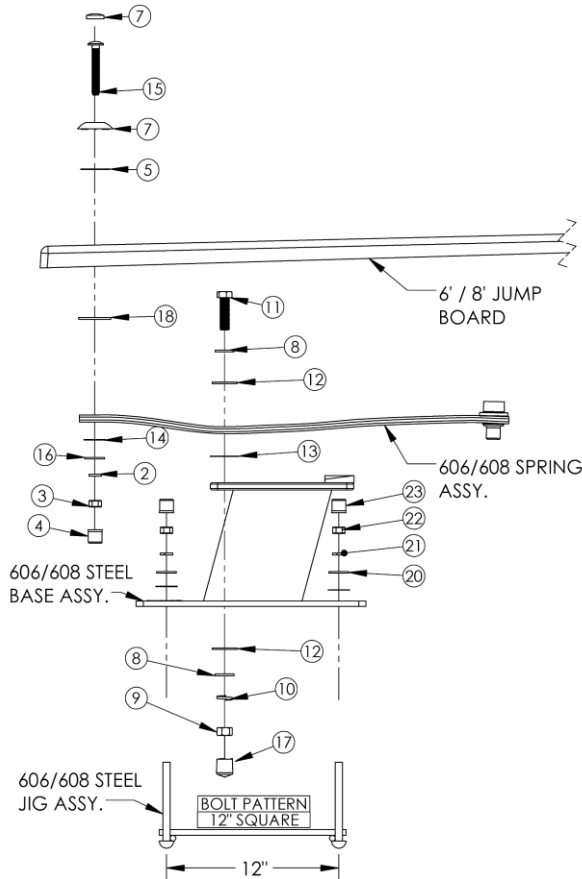

BOLT FULCRUM ASSEMBLY TO THIS END WHERE THE LABEL "CORRECT FULCRUM LOCATION" IS ATTACHED

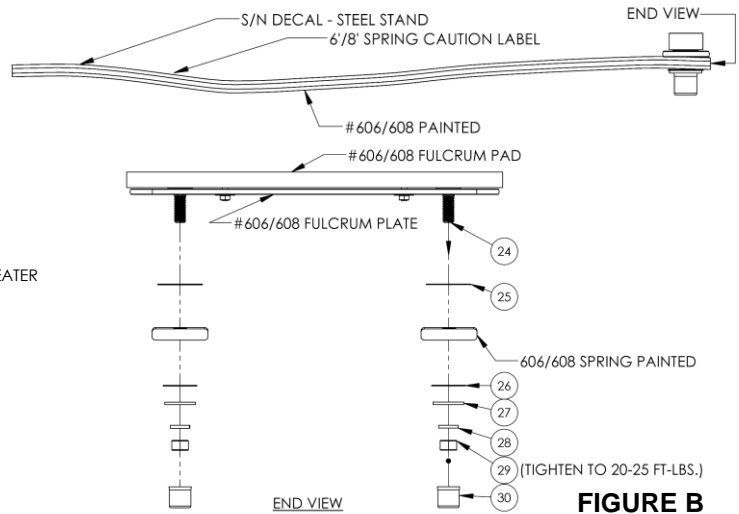

**FIGURE B**

RESIDENTIAL KIT (67-209-911-SS)  
**(FOR FREESTYLE AND HIPHOP BOARDS, REFER TO INSTRUCTION INCLUDED WITH BOARD)**

1. 1/2" X 4-1/2" CARRIAGE BOLT S/S (2 EA.) (a)
2. 1/2" LOCK WASHER S/S (2 EA.)
3. 1/2" HEX NUT SILICONE BRONZE (2 EA.)
4. 1/2" PLASTIC NUT CAP (2 EA.)
5. 1/2" X 2" BLACK RUBBER MOUNTING WASHER (4 EA.) (b)
6. 1/2" X 2" FLAT WASHER S/S (2 EA.) (a)
7. PLASTIC RECESSED MOUNTING WASHER ASM (2 EA.)

(a) NOT USED IN 606/608 ASSEMBLY  
 (b) ONLY 2 REQUIRED FOR 606/608 ASSEMBLY

606/608 SPRING BOLT KIT (69-209-029-SS)

8. 5/8" X 1-3/4" FLAT WASHER S/S (4 EA.)
9. 5/8" HEX NUT S/S (2 EA.)
10. 5/8" LOCK WASHER S/S (2 EA.)
11. 5/8" X 2-1/4" HEX HEAD BOLT S/S (2 EA.)
12. 5/8" X 1-3/4" NYLON PROTECTIVE WASHER (4 EA.)
13. 5/8" X 2" SQUARE NYLON WASHER (2 EA.)
14. 1/2" X 1-1/2" ROUND NYLON WASHER (2 EA.)
15. 1/2" - 13 X 3 1/2" CARRIAGE BOLT (2 EA)
16. 1/2" X 1-3/8" FLAT WASHER S/S (2 EA.)
17. 5/8" NUT CAP - WHITE RUBBER (2 EA.)
18. 2 1/4" SQUARE X 1/8" THICK COMPOSITE SPRING PAD (2 EA.)

606/608 STEEL STAND BOLT KIT (69-209-021-SS)

19. 1/2" X 1-1/2" ROUND NYLON WASHER (4 EA.)
20. 1/2" X 1-3/8" FLAT WASHER S/S (4 EA.)
21. 1/2" LOCK WASHER S/S (4 EA.)
22. 1/2" HEX NUT SILICONE BRONZE (4 EA.)
23. 1/2" PLASTIC NUT CAP (4 EA.)

606/608 FULCRUM BOLT KIT (69-209-020-SS)

24. 1/2" X 1-1/2" CARRIAGE BOLT-S/S (2 EA.)
25. 5/8" X 2" SQ. NYLON WASHER (2 EA.)
26. 1/2" X 1-1/2" ROUND NYLON WASHER (2 EA.)
27. 1/2" X 1-3/8" FLAT WASHER-S/S (2 EA.)
28. 1/2" LOCK WASHER-S/S (2 EA.)
29. 1/2" HEX NUT SILICONE BRONZE (2 EA.)
30. 1/2" HEX NUT CAP (2 EA.)

# 656/658 SUPREME FIBERGLASS JUMP STAND MOUNTING KIT

**FIGURE A**

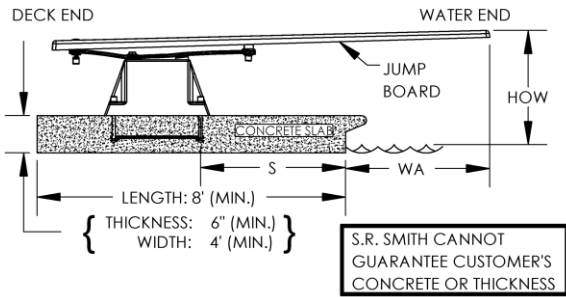

**TIGHTENING SCHEDULE**

1. SECURE STAND TO JIG WITH ANCHOR HEX NUTS AT 40-50 FT-LBS
2. SECURE SPRING TO STAND WITH MOUNTING HEX NUTS AT 40-50 FT-LBS
3. SECURE BOARD TO STAND WITH MOUNTING HEX NUTS AT 20-25 FT-LBS

BOLT FULCRUM ASSEMBLY TO THIS END WHERE THE LABEL "CORRECT FULCRUM LOCATION" IS ATTACHED

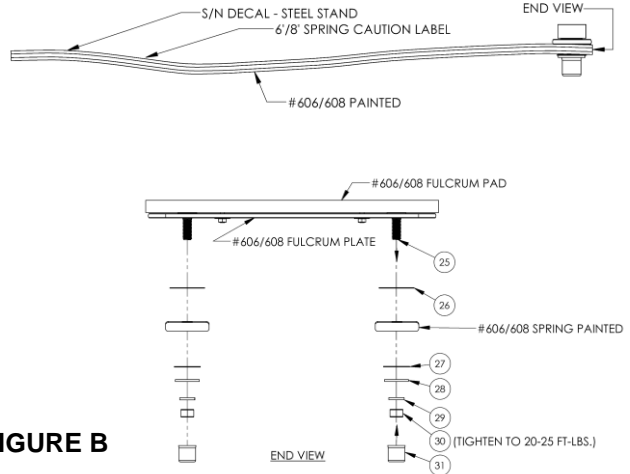

**FIGURE B**

**RESIDENTIAL KIT (67-209-911-SS)  
(FOR FREESTYLE AND HIPHOP BOARDS, REFER TO INSTRUCTION INCLUDED WITH BOARD)**

1. 1/2" X 4-1/2" CARRIAGE BOLT S/S (2 EA.) (a)
2. 1/2" LOCK WASHER S/S (2 EA.)
3. 1/2" HEX NUT SILICONE BRONZE (2 EA.)
4. 1/2" PLASTIC NUT CAP (2 EA.)
5. 1/2" X 2" BLACK RUBBER MOUNTING WASHER (4 EA.) (b)
6. 1/2" X 2" FLAT WASHER S/S (2 EA.) (a)
7. WHITE PLASTIC RECESSED MOUNTING WASHER ASS'Y (2 EA.)

(a) NOT USED IN 656/658 ASSEMBLY  
(b) ONLY 2 USED IN 656/658 ASSEMBLY

**606/608 SPRING BOLT KIT (69-209-029-SS)**

8. 5/8" x 1-3/4" FLAT WASHER S/S (4 EA.)
9. 5/8" HEX NUT S/S (2 EA.)
10. 5/8" LOCK WASHER S/S (2 EA.)
11. 5/8" X 2-1/4" HEX HEAD BOLT S/S (2 EA.)
12. 5/8" X 1-3/4" NYLON PROTECTIVE WASHER (4 EA.)
13. 5/8" X 2" SQUARE NYLON WASHER (2 EA.)
14. 1/2" X 1-1/2" ROUND NYLON WASHER (2 EA.)
15. 1/2-13" - 3 1/2" CARRIAGE BOLT (2 EA.)
16. 1/2" X 1-3/8" FLAT WASHER S/S (2 EA.)
17. 5/8" NUT CAP - WHITE RUBBER (2 EA.)
18. 2 1/4" SQUARE X 1/8" THICK COMPOSITE SPRING PAD (2 EA.)

**656/658 SUPREME STAND BOLT KIT (69-209-017-SS)**

19. 5/8" X 2" SQUARE WASHER PLATE S/S (2 EA.)
20. 1/2" X 1-3/8" FLAT WASHER S/S (4 EA.)
21. 1/2" LOCK WASHER S/S (4 EA.)
22. 1/2" HEX NUT SILICONE BRONZE (4 EA.)
23. 1/2" PLASTIC NUT CAP (4 EA.)
24. 5/8" X 3" HEX HEAD BOLT S/S (2 EA.)
- REPLACES #11 FROM 606/608 SPRING BOLT KIT.

**606/608 FULCRUM BOLT KIT (69-209-020-SS)**

25. 1/2" X 1-1/2" CARRIAGE BOLT S/S (2 EA.)
26. 5/8" X 2" SQUARE NYLON WASHER (2 EA.)
27. 1/2" X 1-1/2" ROUND NYLON WASHER (2 EA.)
28. 1/2" X 1-3/8" FLAT WASHER S/S (2 EA.)
29. 1/2" LOCK WASHER S/S (2 EA.)
30. 1/2" HEX NUT SILICONE BRONZE (2 EA.)
31. 1/2" HEX NUT CAP (2 EA.)

**FIGURE C**

