

RING RAIL STABILIZING PLUG

PART# 140



Made of 100%
bullet aluminum A
6" plug that allows
you to fix the
weakest handrail.

**Four Required
(Sold per Each)**

1. Remove handrail from anchor cup.
2. File down any rough inside edges.
3. Turn the handrail upside down and drive the plug in with a heavy hammer or sledge.
4. When the plug is completely inserted, it will cause the handrail to become round, allowing the anchor wedge to be securely tightened.
5. Before reinstalling the handrail, completely cover the end of plug with silicone. Allow 20 min. to cure. This will protect plug from oxidation.

Tools Needed

- HAMMER
- FILE or SANDPAPER
- SILICONE

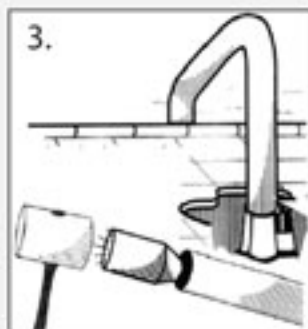

POOL TOOL CO.

View our online catalog at pooltool.com

805.644.2333

Available at your local distributor