

# HANDRAIL STABILIZING PLUG

PART# 136-A or B



**Made of carbon fiber that allows you to fix the weakest handrail.**

1. Remove handrail from anchor cup.
2. File down any rough inside edges.
3. Turn the handrail upside down and drive the plug in with a heavy hammer or sledge.
4. When the plug is completely inserted, it will cause the handrail to become round, allowing the anchor wedge to be securely tightened.

If you have any questions, please call Herb at 805-644-2333.

## Tools Needed

- HAMMER
- FILE or SANDPAPER

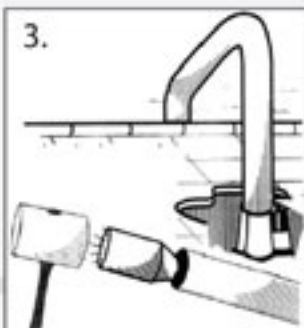

**POOL TOOL COMPANY®**  
pooltool.com

\*Our catalog is available online\*

**Phone:** 805-644-2333

**Address:**  
4848 Colt st. #10  
Ventura CA 93003