



## PS SERIES™ IN-LINE STRAINER FOR COMMERCIAL PUMPS

PROVEN PERFORMANCE UNDER DEMANDING CONDITIONS



PS Series strainers from Pentair Commercial Aquatics™ are designed for ease of installation and hydraulic efficiencies in commercial aquatics applications. In three standard sizes and with the addition of eccentric reducers, PS Series strainers

fit with almost any plumbing configuration. The design of the PS Series strainers accommodates the high-flow performance in a variety of applications. ANSI Rated flange bolt pattern allows for ease of installation and peace of mind.

### STANDARD FEATURES

- Superior design for hydraulic performance.
- Clear lid with easy access allows for simple visibility of debris.
- Extra-large stainless steel strainer basket.
- 50 psi rating.
- NSF listed.

### ENGINEERING SPECIFICATIONS

- The strainer shall consist of a nonmetallic fiberglass-reinforced plastic body, a clear cover that extends over the entire top, an O-ring seal, manually capable (no tools required) stainless steel/plastic screw fasteners, and a stainless steel basket.
- The strainer body shall be able to be fitted with PVC plastic piping connections. These connections shall be capable of accommodating Van Stone Flanges, concentric reducers, and non-concentric reducers. The strainer shall have a removable drain for winterizing and a pressure relief valve set at 50 psi.
- The strainer pipe sizes and basket characteristics shall meet and be listed to NSF/ANSI Rated Standard 50.

# PS SERIES™ IN-LINE STRAINER FOR COMMERCIAL PUMPS

## NECESSARY HARDWARE

Model Designation		Connection Size (inlet x outlet)	Inlet		Outlet	
			Bolt Size	Number	Bolt Size	Number
<b>PS6:</b>		6 in. pipe x 6 in. pipe	no bolts		no bolts	
PS6X6	Plastic Flanged	6 in. ANSI x 6 in. ANSI	3/4 in.	8	3/4 in.	8
PS6X5E	Plastic Flanged Eccentric	6 in. ANSI x 5 in. ANSI	3/4 in.	8	3/4 in.	8
PS6X4E	Plastic Flanged Eccentric	6 in. ANSI x 4 in. ANSI	3/4 in.	8	5/8 in.	8
PS6X3E	Plastic Flanged Eccentric	6 in. ANSI x 3 in. ANSI	3/4 in.	8	5/8 in.	4
PS#X#E	Plastic Flanged Eccentric	Various Standard Reducers	various		various	
<b>PS8:</b>		8 in. pipe x 8 in. pipe	no bolts		no bolts	
PS8X8	Plastic Flanged	8 in. ANSI x 8 in. ANSI	3/4 in.	8	3/4 in.	8
PS8X6E	Plastic Flanged Eccentric	8 in. ANSI x 6 in. ANSI	3/4 in.	8	3/4 in.	8
PS8X5E	Plastic Flanged Eccentric	8 in. ANSI x 5 in. ANSI	3/4 in.	8	3/4 in.	8
PS8X4E	Plastic Flanged Eccentric	8 in. ANSI x 4 in. ANSI	3/4 in.	8	3/4 in.	8
PS#X#E	Plastic Flanged Eccentric	Various Standard Reducers	various		various	
<b>PS10:</b>		10 in. pipe x 10 in. pipe	no bolts		no bolts	
PS10X10	Plastic Flanged	10 in. ANSI x 10 in. ANSI	7/8 in.	12	7/8 in.	12
PS10X8E	Plastic Flanged Eccentric	10 in. ANSI x 8 in. ANSI	7/8 in.	12	3/4 in.	8
PS10X6E	Plastic Flanged Eccentric	10 in. ANSI x 6 in. ANSI	7/8 in.	12	3/4 in.	8
PS10X5E	Plastic Flanged Eccentric	10 in. ANSI x 5 in. ANSI	7/8 in.	12	3/4 in.	8
PS#X#E	Plastic Flanged Eccentric	Various Standard Reducers	various		various	

NOTE: # designation indicates optional available reducers.  
 Suffix E denotes Eccentric reducers, Suffix C denotes Concentric reducers.  
 Suffix E will be replaced with C if Concentric reducer is used.

## ENGINEERING SPECIFICATIONS

Model	PS6	PS8	PS10
Inlet Pipe Size	6 in. (DIN 150)	8 in. (DIN 200)	10in. (DIN 250)
Maximum Pressure	50 psi (345 kPa)	50 psi (345 kPa)	50 psi (345 kPa)
Maximum Temperature	125° F (50° C)	125° F (50° C)	125° F (50° C)
Maximum Flow Rate	540 GPM (2040 LPM)	930 GPM (3520 LPM)	1470 GPM (5560 LPM)
Basket Open Area	224 sq. in. (1445 sq. cm)	224 sq. in. (1445 sq. cm)	335 sq. in. (2161 sq. cm)
Cover Material	Clear Acrylic	Clear Acrylic	Clear Acrylic
Basket Material	Stainless Steel	Stainless Steel	Stainless Steel
Body Material	Engineered Fiberglass	Engineered Fiberglass	Engineered Fiberglass

## DIMENSIONAL DATA

Strainer Size	"OD"	"A"	"B"	"C"
6	12.8	13.6	25.5	22.8
8	12.8	13.6	25.5	22.8
10	12.8	20.6	32.5	22.8

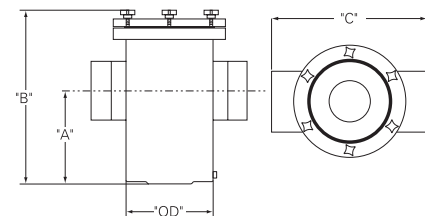

1620 HAWKINS AVE, SANFORD, NC 27330 800.831.7133 WWW.PENTAIRCOMMERCIAL.COM

All Pentair trademarks and logos are owned by Pentair or one of its global affiliates. PS Series™ and Pentair Commercial Aquatics™ are trademarks of Pentair Water Pool and Spa, Inc. and/or its affiliated companies in the United States and/ or other countries. Because we are continuously improving our products and services, Pentair reserves the right to change specifications without prior notice. Pentair is an equal opportunity employer.