

Ref	Description	Qty	Part #
1	Captains wheel, 6 spoke	2	*
2	Lane storage reel side "A" frame	2	75101B
3	Bottom frame side braces (pair)	1	75106 **
4	Bottom frame end braces (pair)	1	75106B
5	Lane storage reel axle	1	75107 ***
6	Locking caster	4	****
7	Axle bearing (Factory Installed)	2	75120A
8	Axle stop bushing	2	75122A
9	5/16"-18 X 2 1/4" Round head bolt s/s	12	94317
10	5/16"-18 X 3/4" Round head bolt, s/s	4	94326
11	5/16" Split lockwasher, s/s	20	94448
12	5/16" Acorn cap nut, s/s	16	94406
13	5/16" Elastic stop nut/ s/s	2	94452
14	5/16"-24 X 1 1/2" Hex head bolt, s/s	8	94440
15	Square end cap, black (Factory Installed)	4	22612
16	5/16"-18 X 2 1/4" Hex head bolt s/s	2	94417

See notes on page 2 of 2.

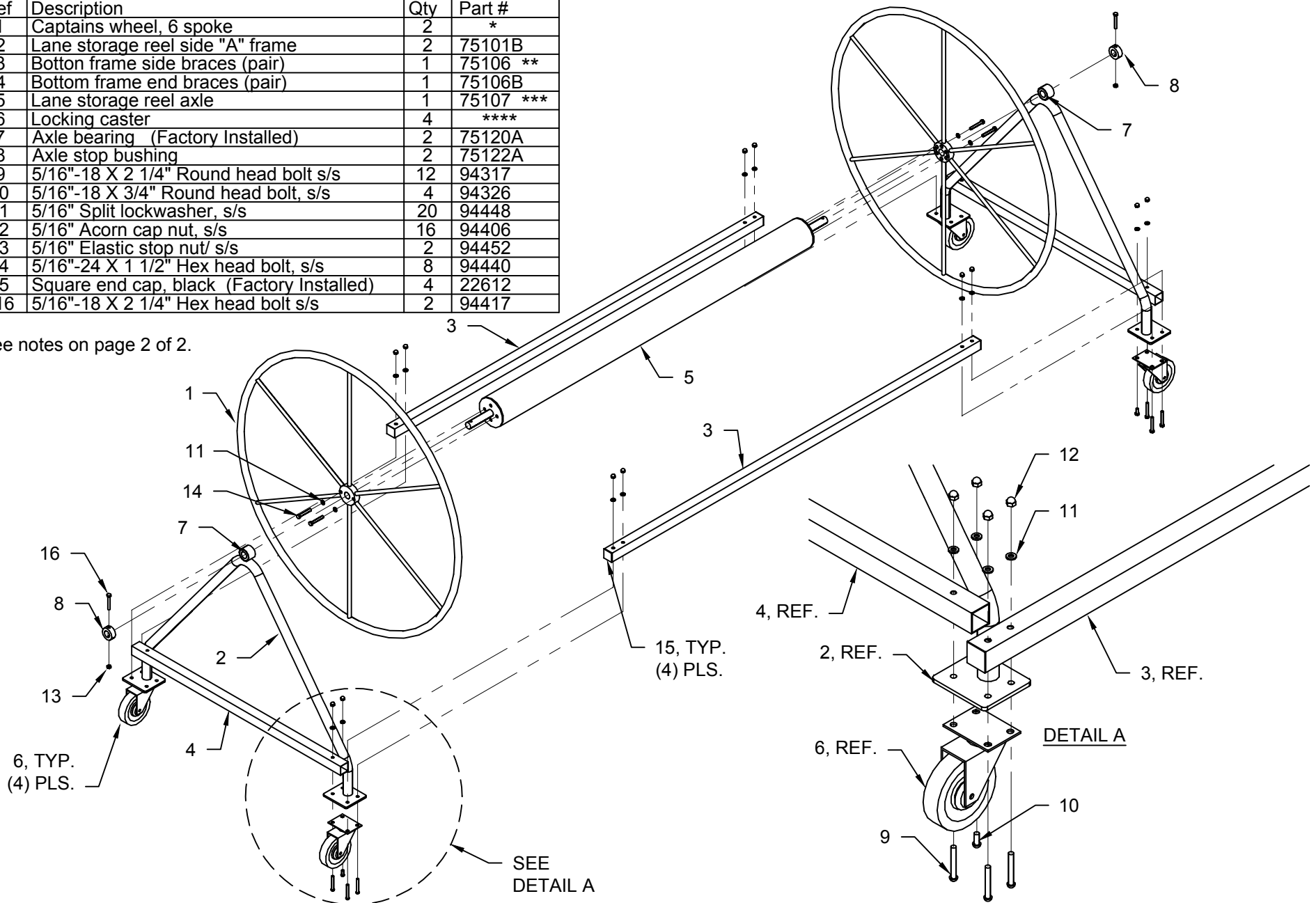

The data represent the latest knowledge available to us at time of presentation. However Paragon Aquatics and others involved in gathering and presenting this drawing assume no liability for its use.  
 © 2012 Paragon Aquatics

**PARAGON AQUATICS**  
 Pentair Water

1351 Route 55  
 LaGrangeville, NY 12540  
 Phone: (845) 452-5500  
 Fax: (845) 452-5426

Dwn by: JMM	Date: 6/15/12	Title: <b>LANE STORAGE REEL ASSEMBLY DRAWING</b>		Material: SEE NOTES/SCHEDULE	
App by: JMM	Date: 6/15/12	Drawing Number: <b>AI-PA40.01</b>	Tolerance: (Unless noted) N/A	Scale: N/A	Rev Ltr: I
				Sheet: 1 OF 2	

**General Notes:**

- Lane storage reels are available in four configurations:
  - (75101) standard capacity with zinc plated casters
  - (75101ss) standard capacity with stainless steel casters
  - (75111) large capacity with zinc plated casters
  - (75111ss) large capacity with stainless steel casters
 See parts schedule and notes below for part identification.

**Special Notes:**

- \* - Two sizes are available:
  - (75101c) - standard capacity captains wheel
  - (75101f) - large capacity captains wheel
- \*\* - Bottom frame side frame braces are sold as a pair and include:
  - (4) square black plastic end caps (ref. 14), (2) per side
- \*\*\* - When ordered seperately, axles also include the following parts:
  - (2) axle stop bushing (ref. 8)
  - (2) 5/16"-18 x 2 1/4" Hex head bolt (ref. 16)
  - (2) 5/16" elastic stop nut (ref. 13)
  - (4) 5/16"-24 x 1 1/2" hex head bolt (ref. 14)
  - (4) 5/16" split lockwashers (ref. 11)
- \*\*\*\* - Two caster material options are available:
  - (75101d) - set of (4) zinc plated casters and hardware
  - (75101e) - set of (4) stainless steel caster and hardware
 Both part numbers include the following hardware:
  - (12) 5/16"-18 x 2 1/4" hex head bolt, s/s (ref. 9)
  - (4) 5/16"-18 x 3/4" Round head bolt, s/s (ref. 10)
  - (16) 5/16" split lockwasher, s/s (ref. 11)
  - (16) 5/16" acorn nut, s/s (ref. 12)
 Individual casters (less hardware) can be ordered as:
  - (75103) - zinc plated caster
  - (75103ss) - stainless steel caster
 A caster hardware kit (93971) is available which includes:
  - (12) 5/16"-18 x 2 1/4" Round head bolt, s/s (ref. 9)
  - (4) 5/16"-18 x 3/4" Round head bolt, s/s (ref. 10)
  - (20) 5/16" split lockwasher, s/s (ref. 11)
  - (16) 5/16" acorn nut, s/s (ref. 12)
  - (4) 5/16"-24 x 1 1/2" hex head bolt (ref. 14)

**Assembly Instructions**

**Note:** Do not fully tighten hardware during initial installation. Only after assembly is completed and tested should you fully tighten all hardware. Two people are recommended for safe assembly.

- Verify that you have received all parts shown on page 1. Please note that some parts may already be pre-installed.
- Slide the captains wheels (ref. 1) on to the axle (ref.5) shafts making sure that the welded side of the captains wheel hubs are facing towards the center of the axle. Insert the axle shaft ends into the tops of the side "A" frames (ref. 2) so the axle and captains wheels are supported by the "A" frames on a firm, level surface as shown in Figure 1 below.

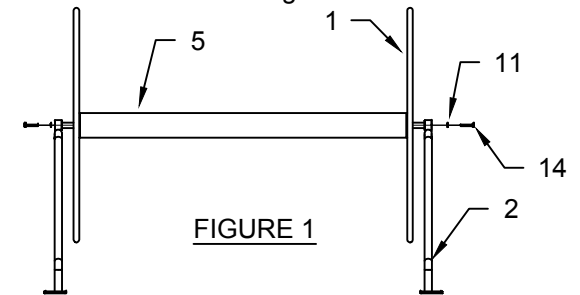

- Align the holes on the captains wheel hubs with the holes on the ends of the axle shaft. **BY HAND**, thread the mounting bolts (ref. 14) and lockwasher (ref. 11) through the hub and into the axle ends. **BE CAREFUL NOT TO CROSS THREAD THE BOLTS.** Bolts should thread easily and should be threaded by hand until the lockwash contacts the captains wheel hub. Note, only two bolts are used to attach each captains wheel.
- Install the axle stop bushings (ref. 8) on to the ends of the axle shaft. Align the holes of the bushings with those on the ends of the axle shaft. Install bolts (ref. 16.) and nuts (ref. 13) into both bushings.
- Position the assembly so that the "A" frames are horizontal (sideways) on the floor placing two of the caster mounting plates at about waist level.
- Align the holes of casters (ref. 6) with the holes on one of the side "A" frame (ref. 2) mounting plates and side brace (ref. 3). Install 5/16" Round head bolts (ref. 10), 5/16" lockwashers (ref. 11), and 5/16" cap nuts (ref. 12) on both "A" frame mounting plates securing the side frame brace to the "A" frame and caster. See Detail A on page 1. Please note that cap nuts should be on the opposite side of the mounting plate from the caster wheel.
- Rotate side "A" frames about the axle so that the second set of mounting plates is at waist level. Repeat step 5.
- Turn lane storage reel to upright position so that it is not supported by the caster wheels. Install end frame braces (ref. 4) using hardware shown in Detail A on page 1.
- Install black square end caps (ref. 15) as shown into side frame braces.
- Inspect and test the unit making sure that the axle assembly turns smoothly. Make adjustments if necessary. Fully tighten all hardware.

The data represent the latest knowledge available to us at time of presentation. However Paragon Aquatics and others involved in gathering and presenting this drawing assume no liability for its use.

© 2012 Paragon Aquatics



1351 Route 55  
LaGrangeville, NY 12540  
Phone: (845) 452-5500  
Fax: (845) 452-5426

Dwn by: Date: JMM 6/15/12	Title: <b>LANE STORAGE REEL ASSEMBLY DRAWING</b>		Material: SEE NOTES/SCHEDULE	
App by: Date: JMM 6/15/12	Drawing Number: <b>AI-PA40.01</b>	Tolerance: (Unless noted) N/A	Scale: N/A	Rev Ltr: Sheet: I 2 OF 2