



**ENERGYRITE®
VENTING OPTIONS
Submittal Sheet**

ERVO-Sub-02

ENERGYRITE VENTING OPTIONS (152-402)

JOB NAME _____ **LOCATION** _____
ARCH./ENGR. _____ **WHOLESALE** _____
MECH. CONTRACTOR _____ **MODEL NO.** _____

CONVENTIONAL VENTING

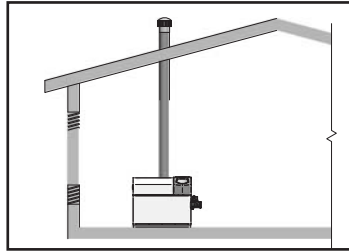

NOTE: Flue Adapter supplied with all indoor vent kits.

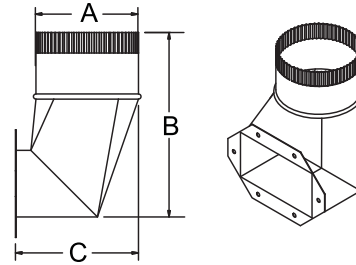

Models 152-402

Lochinvar supplies the flue adapter and air inlet cover. Contractor to supply Type "B" vent pipe material, exhaust vent cap on heater flue and air inlet pipe.

| KIT NO. | MODEL | A | B | C |
|---------|---------|----|----|----|
| CVK3004 | 152-202 | 5" | 9" | 6" |
| CVK3005 | 252 | 6" | 9" | 7" |
| CVK3006 | 302-402 | 6" | 9" | 7" |

DIRECTAIRE VERTICAL VENTING W/ ROOFTOP INLET

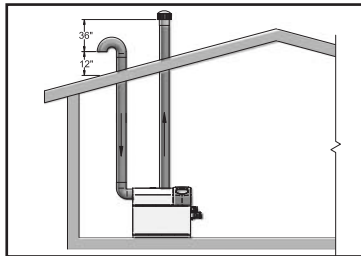

Models 152-402

Lochinvar supplies the flue adapter and air inlet collar. Contractor to supply Type "B" vent pipe material, exhaust vent cap on heater flue and air inlet pipe. Maximum length 50 equivalent feet each.

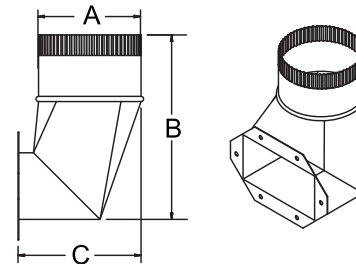

| KIT NO. | MODEL | A | B | C |
|---------|---------|----|----|----|
| VDK3043 | 152-202 | 5" | 9" | 6" |
| VDK3044 | 252 | 6" | 9" | 7" |
| VDK3045 | 302-402 | 6" | 9" | 7" |

DIRECTAIRE VERTICAL VENTING W/ SIDEWALL INLET

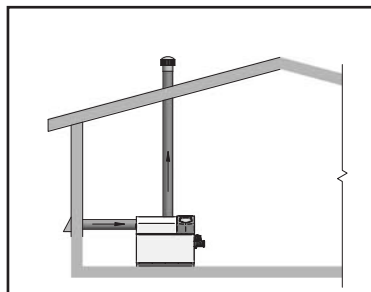

Models 152-402

Lochinvar supplies the flue adapter, air inlet collar and sidewall air inlet cap. Contractor to supply Type "B" vent pipe material, exhaust vent cap on heater flue and air inlet pipe. Maximum length 50 equivalent feet.

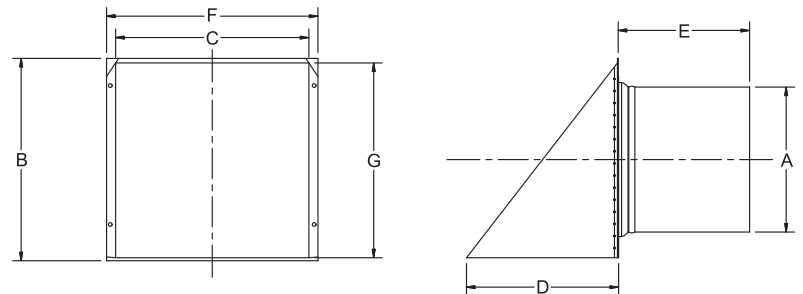

| KIT NO. | FOR MODEL | A | B | C | D | E | F | G |
|---------|-----------|----|--------|--------|--------|--------|--------|---------|
| VDK3040 | 152-202 | 4" | 9-1/8" | 6-7/8" | 3-1/2" | 2-1/2" | 7-1/8" | 9-3/16" |
| VDK3041 | 252 | 5" | 9" | 8" | 4" | 2-1/2" | 9" | 8-1/2" |
| VDK3042 | 302-402 | 5" | 9" | 8" | 4" | 2-1/2" | 9" | 8-1/2" |

E-RITE SIDEWALL VENTING

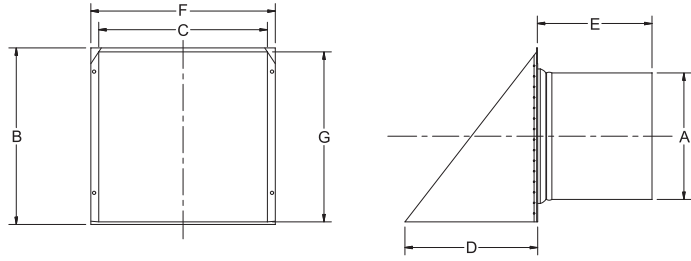
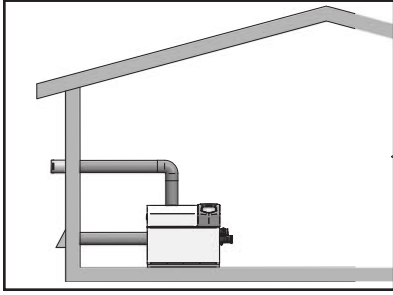

Models 152-402

Lochinvar supplies the flue transition box, inlet air collar, and sidewall air inlet cap. Contractor to supply air inlet, pipe, and AL29-4C stainless steel flue exhaust and vent terminations. Maximum vent length is 20 equivalent feet.

| KIT NO. | MODEL | A | B | C | D | E | F | G |
|---------|---------|----|--------|--------|--------|--------|--------|---------|
| HDK3045 | 152-202 | 4" | 9-1/8" | 6-7/8" | 3-1/2" | 2-1/2" | 7-1/8" | 9-3/16" |
| HDK3046 | 252 | 5" | 9" | 8" | 4" | 2-1/2" | 9" | 8-1/2" |
| HDK3047 | 302 | 5" | 9" | 8" | 4" | 2-1/2" | 9" | 8-1/2" |
| HDK3048 | 402 | 5" | 9" | 8" | 4" | 2-1/2" | 9" | 8-1/2" |

POWERED SIDEWALL VENTING

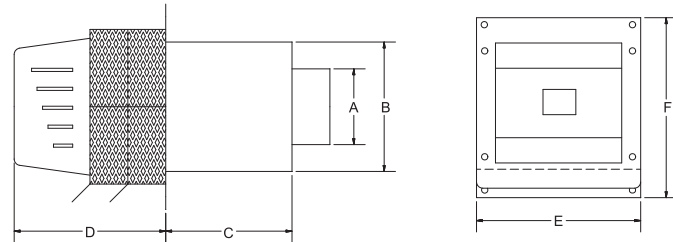
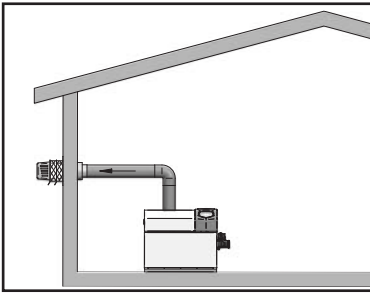

Models 152-402

Lochinvar supplies the flue Adapter, inlet air cover, barometric damper, powered vent cap and proving switch. Contractor to supply Type "B" vent pipe material from heater to vent outlet. 120 VAC required to operate vent cap. Maximum vent length 75 equivalent feet.

| KIT NO. | MODEL | A | B | C | D | E | F | AMPS |
|---------|---------|----|----|--------|---------|-----|---------|------|
| SVK3060 | 152-202 | 4" | 6" | 9-1/4" | 9-1/2" | 9" | 9" | 1.7 |
| SVK3061 | 252 | 5" | 7" | 9-1/4" | 10-3/4" | 12" | 12"-1/8 | 1.3 |
| SVK3062 | 302 | 5" | 7" | 9-1/4" | 10-3/4" | 12" | 12"-1/8 | 1.3 |
| SVK3063 | 402 | 6" | 8" | 9-1/4" | 10-3/4" | 12" | 12"-1/8 | 2.1 |

POWERED DIRECTAIRE HORIZONTAL VENTING

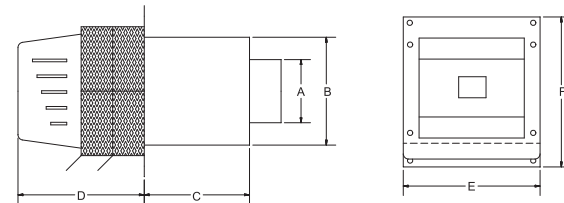
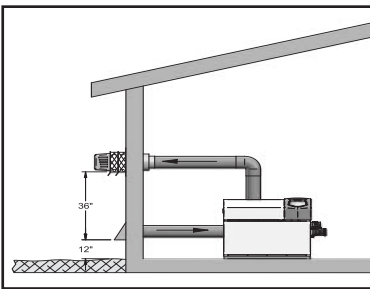

| KIT NO. | MODEL | A | B | C | D | E | F | AMPS |
|---------|---------|----|----|--------|---------|-----|---------|------|
| SVK3064 | 152-202 | 4" | 6" | 9-1/4" | 9-1/2" | 9" | 9" | 1.7 |
| SVK3065 | 252 | 5" | 7" | 9-1/4" | 10-3/4" | 12" | 12"-1/8 | 1.3 |
| SVK3066 | 302 | 5" | 7" | 9-1/4" | 10-3/4" | 12" | 12"-1/8 | 1.3 |
| SVK3067 | 402 | 6" | 8" | 9-1/4" | 10-3/4" | 12" | 12"-1/8 | 2.1 |

Models 152-402

Lochinvar supplies the flue Adapter, inlet air collar, powered vent cap, barometric damper proving switch, and sidewall air inlet cap. Contractor to supply Type "B" vent pipe material from heater to vent outlet and single wall air inlet pipe. 120 VAC required to operate vent cap. Maximum vent length 75 equivalent feet.

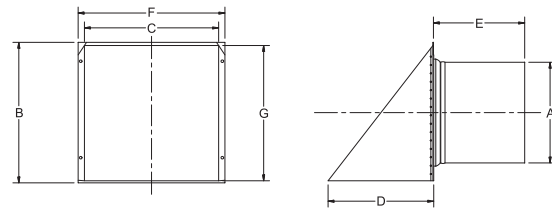

| KIT NO. | MODEL | A | B | C | D | E | F | G |
|---------|---------|----|--------|--------|--------|--------|--------|---------|
| SVK3064 | 152-202 | 4" | 9-1/8" | 6-7/8" | 3-1/2" | 2-1/2" | 7-1/8" | 9-3/16" |
| SVK3065 | 252 | 5" | 9" | 8" | 4" | 2-1/2" | 9" | 8-1/2" |
| SVK3066 | 302 | 5" | 9" | 8" | 4" | 2-1/2" | 9" | 8-1/2" |
| SVK3067 | 402 | 5" | 9" | 8" | 4" | 2-1/2" | 9" | 8-1/2" |



Lochinvar, LLC • 300 Maddox Simpson Pkwy • Lebanon, TN 37090 • 615-889-8900/Fax: 615-547-1000
www.Lochinvar.com