

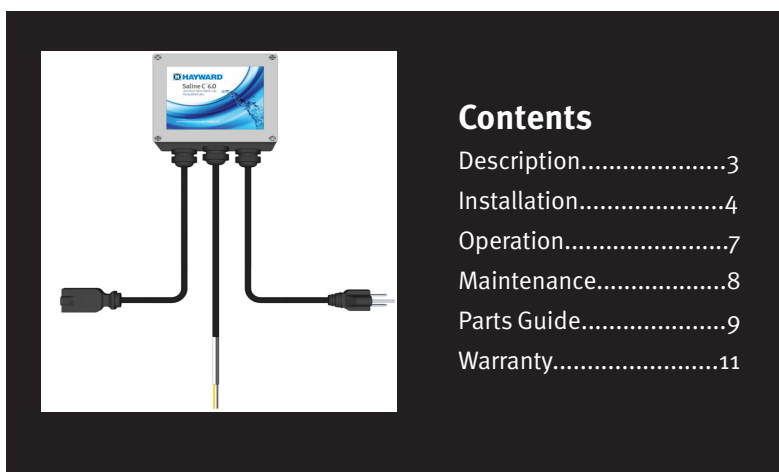

Saline C 6.0 Junction Box

Junction Box for Saline C 6.0 Commercial Salt Chlorine Generator

Owner's Manual



HCSJBOX-BU

IMPORTANT SAFETY INSTRUCTIONS

Basic safety precautions should always be followed, including the following: Failure to follow instructions can cause severe injury and/or death.

⚠ This is the safety-alert symbol. When you see this symbol on your equipment or in this manual, look for one of the following signal words and be alert to the potential for personal injury.

⚠ WARNING warns about hazards that could cause serious personal injury, death or major property damage and if ignored presents a potential hazard.

⚠ CAUTION warns about hazards that will or can cause minor or moderate personal injury and/or property damage and if ignored presents a potential hazard. It can also make consumers aware of actions that are unpredictable and unsafe.

The **NOTICE** label indicates special instructions that are important but not related to hazards.

Hayward Commercial Pool Products
 10101 Molecular Drive, Suite 200
 Rockville, MD 20850
 Phone: (800) 657-2287
www.haywardcommercialpool.com



HAYWARD®

IMPORTANT SAFETY INSTRUCTIONS

⚠ WARNING Read, understand, and follow all safety and operation instructions.

Failure to follow safety and operation instructions can result in severe personal injury or death.

⚠ WARNING -Risk of Electric Shock. Hazardous voltage can, shock, burn and cause death or serious property damage. To reduce the risk of electrical shock, connect the equipment assembly to a circuit protected by a ground-fault circuit-interrupter. Do not bury cord. If cord is damaged, replace immediately.

⚠ WARNING – When installing the system, ensure that power is interlocked with the main recirculation pump power source for the pool/spa to ensure that the Saline C 6.0 system cannot operate when the pumps are off.

⚠ WARNING Chemical Hazard. Chemicals can cause burns both internally and externally. To avoid death, serious injury or property damage: Wear eye and skin protection while maintaining or servicing this unit. Do not inhale fumes from the unit.

⚠ CAUTION To reduce risk of injury, do not permit children to use or climb on this product. Closely supervise children at all times. The ANSI/NSPI-4 Standard (above-ground and on-ground pools) advises that components such as the this system, filtration system, pumps, and heaters be positioned to prevent their being used as a means of access to the pool by young children.

⚠ WARNING – Hazardous Pressure. Pool and spa water circulation systems operate under hazardous pressure during start up, normal operation, and after pump shut off. Stand clear of circulation system equipment during pump start up. Failure to follow safety and operation instructions could result in violent separation of the pump housing and cover, and/or filter housing and clamp due to pressure in the system, which could cause property damage, severe personal injury, or death. Before servicing pool and spa water circulation system, all system and pump controls must be in off position and filter manual air relief valve must be in open position. Before starting system pump, all system valves must be set in a position to allow system water to return back to the pool. Do not change filter control valve position while system pump is running. Before starting system pump, fully open filter manual air relief valve. Do not close filter manual air relief valve until a steady stream of water (not air or air and water) is discharged.

Notice: This product should be installed and serviced only by a qualified licensed electrician.

SAVE THESE INSTRUCTIONS



DESCRIPTION

General Information

The HCSJBOX-BU Junction Box is designed to control a 120 VAC, 12 amp maximum, secondary device through the use of a dry low voltage contact on a chemical feeder.

Specifications

Part Number = HCSJBOX-BU

Dimension = 4.5" W x 3.5" H

Weight = 1 Lb.

Receptacle to backup chlorine feeder = 1 ft.

Power cord to outlet = 5 ft.

Wire to CAT controller = 10 ft.

INSTALLATION

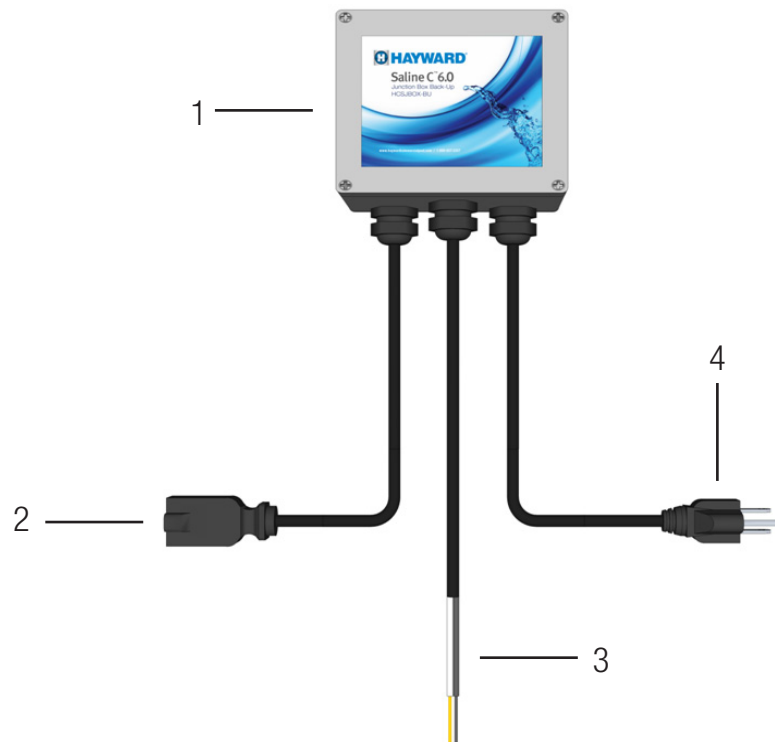

1. Mount the Junction Box within 10 feet of the controller and within 5 feet of a 120V, 15 amp GFCI protected wall outlet.
2. Plug the device being controlled in to the female power cord. This cord will provide 120VAC at 12 amps.
3. Connect this 18/2 cable (Cord #3) to the normally open and common dry contact of the chemical feed controller. The Junction Box will allow chemical feed when the controller closes the contact. The controller contact should be rated for 4Amps, 120 vac.
4. Plug the power cable into a standard 120V, 15Amp Breaker GFCI wall outlet GFCI.

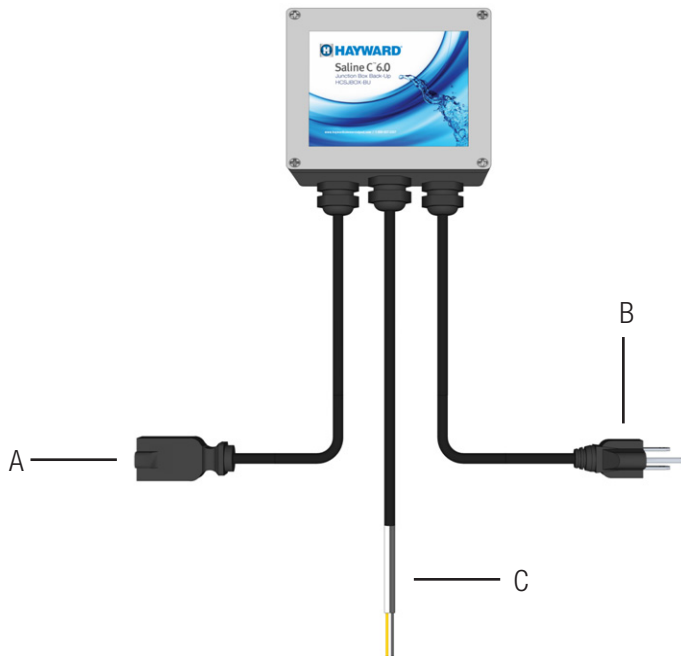

A = Female receptacle for Back-up Chlorine Feeder

B = Plug to 120V outlet

C = 2 Lead low voltage cable for Controller.

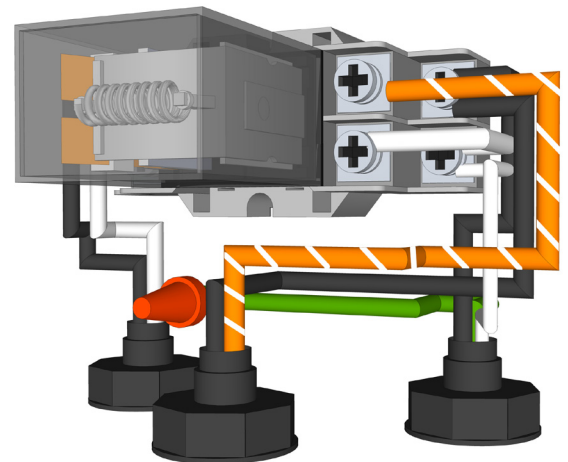
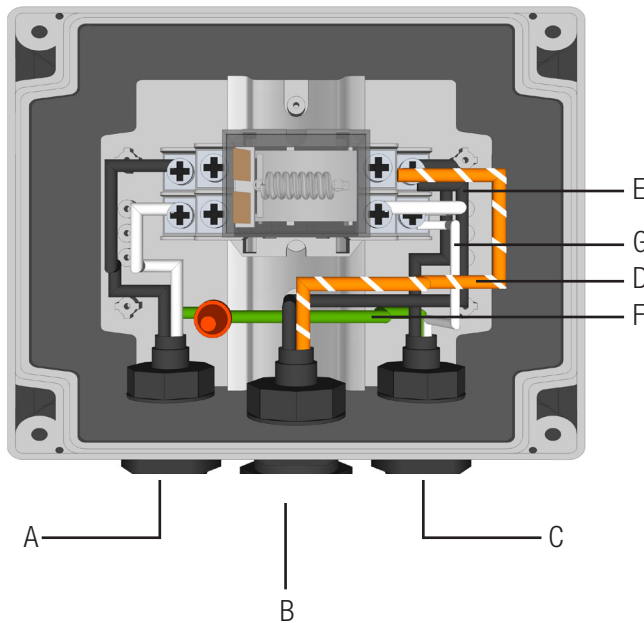

A = Female Pigtails, Plug Saline C 6.0

B = 120v to the Controller

C = Power Cable, 120v

D = Live

E = Live to Controller

F = Ground

G = Neutral

Installing a Saline C 6.0 and back-up chlorine pump with a CAT 2000

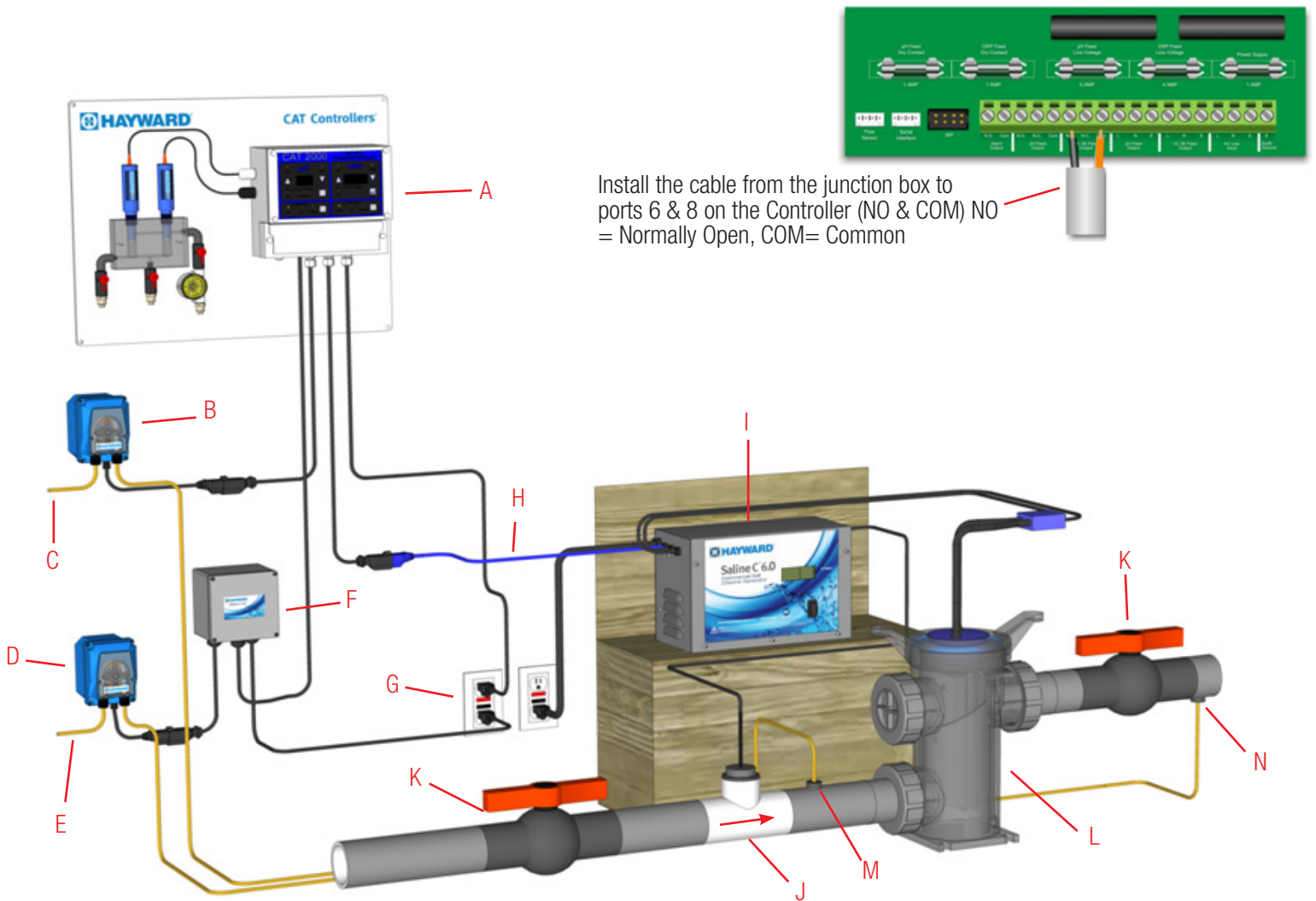

- A = pH & ORP Controller
- B = Acid Pump
- C = Line to Acid Tank
- D = Back-up Chlorine Pump
- E = Line to Chlorine Tank
- F = Junction Box
- G = GFCI Outlet
- H = Blue Control Cord
- I = Saline C 6.0 - Power Supply
- J = Saline C 6.0 - Flow Sensor
- K = Ball Valve
- L = Saline C 6.0 - Salt Cell
- M = Acid Line injection point
- N = Back-up Chlorine Line injection point

Installing a Saline C 6.0 and back-up chlorine pump with a CAT 4000

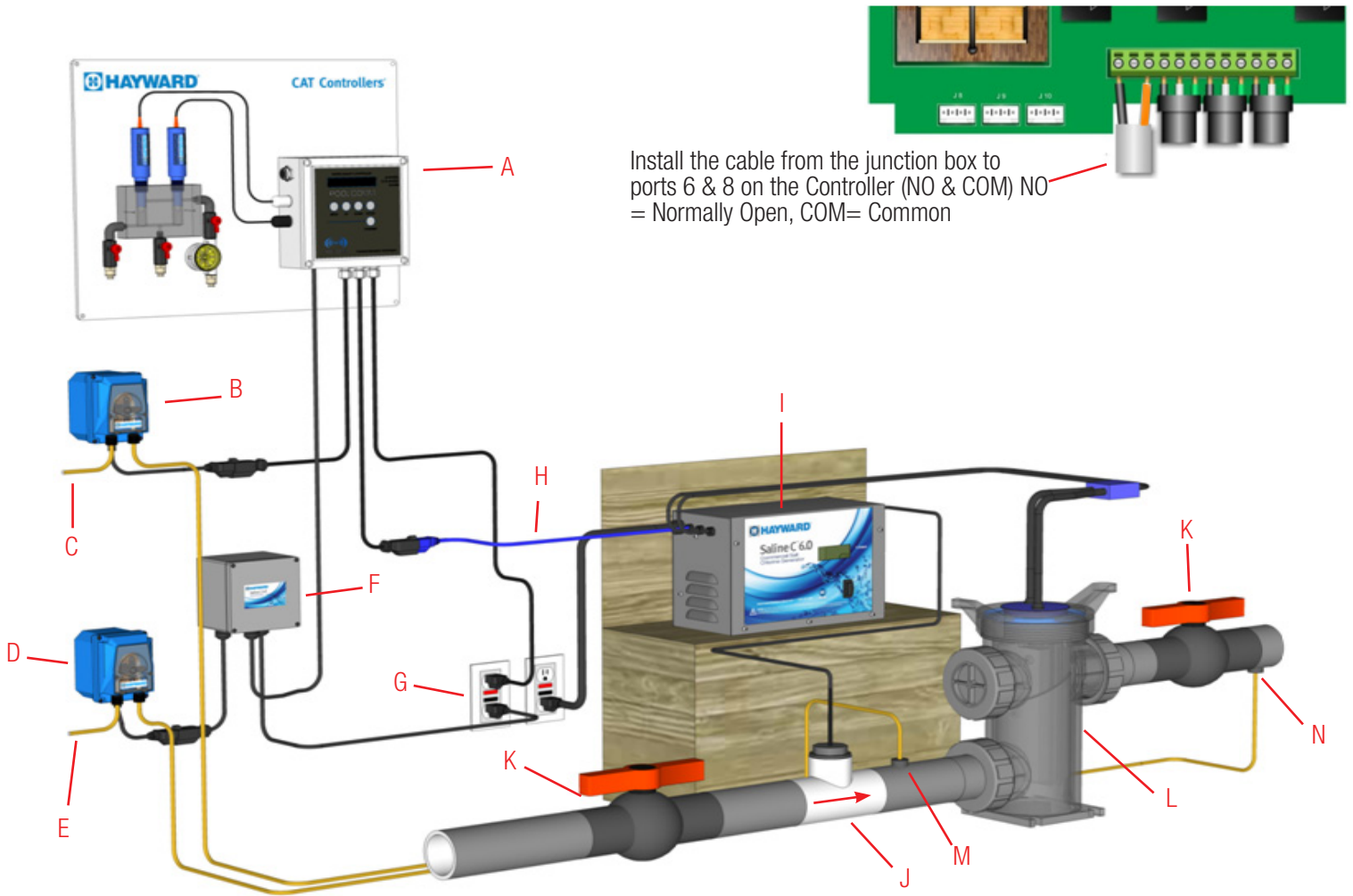

- A = pH & ORP Controller
- B = Acid Pump
- C = Line to Acid Tank
- D = Back-up Chlorine Pump
- E = Line to Chlorine Tank
- F = Junction Box
- G = GFCI Outlet
- H = Blue Control Cord
- I = Saline C 6.0 - Power Supply
- J = Saline C 6.0 - Flow Sensor
- K = Ball Valve
- L = Saline C 6.0 - Salt Cell
- M = Acid Line injection point
- N = Back-up Chlorine Line injection point



Installing a Saline C 6.0 and back-up chlorine pump with a CAT 5000

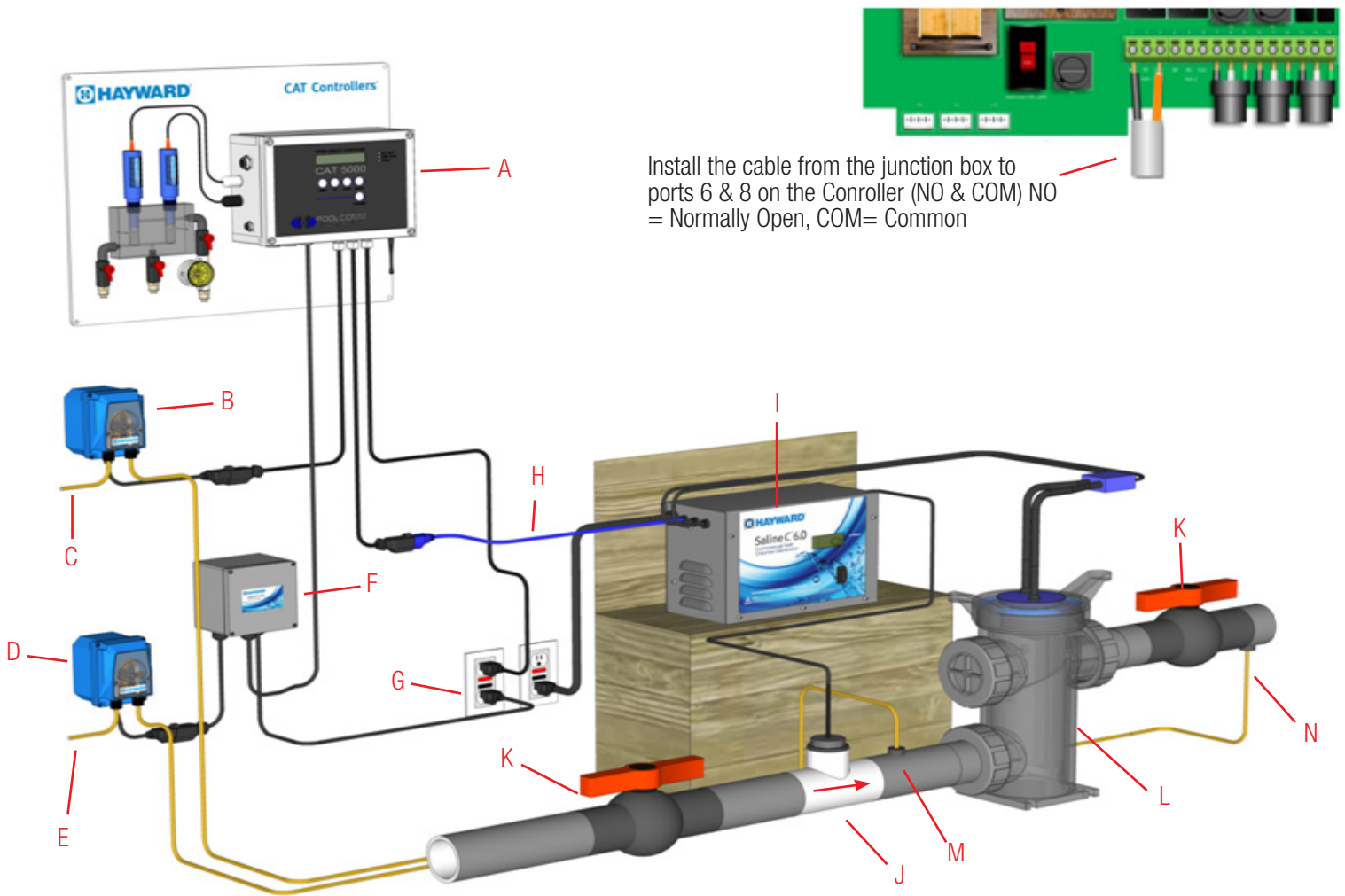

Install the cable from the junction box to ports 6 & 8 on the Controller (NO & COM) NO = Normally Open, COM= Common

- A = pH & ORP Controller
- B = Acid Pump
- C = Line to Acid Tank
- D = Back-up Chlorine Pump
- E = Line to Chlorine Tank
- F = Junction Box
- G = GFCI Outlet
- H = Blue Control Cord
- I = Saline C 6.0 - Power Supply
- J = Saline C 6.0 - Flow Sensor
- K = Ball Valve
- L = Saline C 6.0 - Salt Cell
- M = Acid Line injection point
- N = Back-up Chlorine Line injection point



⚠ WARNING - Read and follow all instructions in this owner's manual and on the equipment. Failure to follow instructions can cause severe injury and/or death.

⚠ WARNING – Suction Entrapment Hazard.



Suction in suction outlets and/or suction outlet covers which are, damaged, broken, cracked, missing, or unsecured can cause severe injury and/or death due to the following entrapment hazards:



Hair Entrapment- Hair can become entangled in suction outlet cover.



Limb Entrapment- A limb inserted into an opening of a suction outlet sump or suction outlet cover that is damaged, broken, cracked, missing, or not securely attached can result in a mechanical bind or swelling of the limb.



Body Suction Entrapment- A negative pressure applied to a large portion of the body or limbs can result in an entrapment.

Evisceration/ Disembowelment - A negative pressure applied directly to the intestines through an unprotected suction outlet sump or suction outlet cover which is, damaged, broken, cracked, missing, or unsecured can result in evisceration/ disembowelment.



Mechanical Entrapment- There is potential for jewelry, swimsuit, hair decorations, finger, toe or knuckle to be caught in an opening of a suction outlet cover resulting in mechanical entrapment.

⚠ WARNING - To Reduce the risk of Entrapment Hazards:

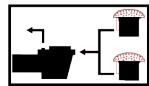

- o When outlets are small enough to be blocked by a person, a minimum of two functioning suction outlets per pump must be installed. Suction outlets in the same plane (i.e. floor or wall), must be installed a minimum of three feet (3') [1 meter] apart, as measured from near point to near point.
- o Dual suction fittings shall be placed in such locations and distances to avoid “dual blockage” by a user.
- o Dual suction fittings shall not be located on seating areas or on the backrest for such seating areas.
- o The maximum system flow rate shall not exceed the flow rating of as listed on Table 1.
- o Never use Pool or Spa if any suction outlet component is damaged, broken, cracked, missing, or not securely attached.
- o Replace damaged, broken, cracked, missing, or not securely attached suction outlet components immediately.
- o In addition two or more suction outlets per pump installed in accordance with latest ASME, APSP Standards and CPSC guidelines, follow all National, State, and Local codes applicable.
- o Installation of a vacuum release or vent system, which relieves entrapping suction, is recommended.

⚠ WARNING – Failure to remove pressure test plugs and/or plugs used in winterization of the pool/spa from the suction outlets can result in an increase potential for suction entrapment as described above.

⚠ WARNING – Failure to keep suction outlet components clear of debris, such as leaves, dirt, hair, paper and other material can result in an increase potential for suction entrapment as described above.

⚠ WARNING – Suction outlet components have a finite life, the cover/grate should be inspected frequently and replaced at least every ten years or if found to be damaged, broken, cracked, missing, or not securely attached.

⚠ CAUTION – Components such as the filtration system, pumps and heater must be positioned so as to prevent their being used as means of access to the pool by young children. To reduce risk of injury, do not permit children to use or climb on this product. Closely supervise children at all times. Components such as the filtration system, pumps, and heaters must be positioned to prevent children from using them as a means of access to the pool.



⚠ WARNING – Hazardous Pressure. Pool and spa water circulation systems operate under hazardous pressure during start up, normal operation, and after pump shut off. Stand clear of circulation system equipment during pump start up. Failure to follow safety and operation instructions could result in violent separation of the pump housing and cover, and/or filter housing and clamp due to pressure in the system, which could cause property damage, severe personal injury, or death. Before servicing pool and spa water circulation system, all system and pump controls must be in off position and filter manual air relief valve must be in open position. Before starting system pump, all system valves must be set in a position to allow system water to return back to the pool. Do not change filter control valve position while system pump is running. Before starting system pump, fully open filter manual air relief valve. Do not close filter manual air relief valve until a steady stream of water (not air or air and water) is discharged.



⚠ WARNING – Separation Hazard. Failure to follow safety and operation instructions could result in violent separation of pump and/or filter components. Strainer cover must be properly secured to pump housing with strainer cover lock ring. Before servicing pool and spa circulation system, filters manual air relief valve must be in open position. Do not operate pool and spa circulation system if a system component is not assembled properly, damaged, or missing. Do not operate pool and spa circulation system unless filter manual air relief valve body is in locked position in filter upper body. **Never operate or test the circulation system at more than 50 PSI.**



⚠ WARNING – Risk of Electric Shock. All electrical wiring **MUST** be in conformance with applicable local codes, regulations, and the National Electric Code (NEC). Hazardous voltage can shock, burn, and cause death or serious property damage. To reduce the risk of electric shock, do **NOT** use an extension cord to connect unit to electric supply. Provide a properly located electrical receptacle. Before working on any electrical equipment, turn off power supply to the equipment. To reduce the risk of electric shock replace damaged wiring immediately. Locate conduit to prevent abuse from lawn mowers, hedge trimmers and other equipment. Do **NOT** ground to a gas supply line.

⚠ WARNING – Risk of Electric Shock Failure to ground all electrical equipment can cause serious or fatal electrical shock hazard. Electrical ground all electrical equipment before connecting to electrical power supply.

⚠ WARNING – Risk of Electric Shock Failure to bond all electrical equipment to pool structure will increase risk for electrocution and could result in injury or death. To reduce the risk of electric shock, see installation instructions and consult a professional electrician on how to bond all electrical equipment. Also, contact a licensed electrician for information on local electrical codes for bonding requirements.

Notes to electrician: Use a solid copper conductor, size 8 or larger. Run a continuous wire from external bonding lug to reinforcing rod or mesh. Connect a No. 8 AWG (8.4 mm²) [No. 6 AWG (13.3 mm²) for Canada] solid copper bonding wire to the pressure wire connector provided on the electrical equipment and to all metal parts of swimming pool, spa, or hot tub, and metal piping (except gas piping), and conduit within 5 ft. (1.5 m) of inside walls of swimming pool, spa, or hot tub.

IMPORTANT - Reference NEC codes for all wiring standards including, but not limited to, grounding, bonding and other general wiring procedures.

⚠ WARNING – Risk of Electric Shock . The electrical equipment must be connected only to a supply circuit that is protected by a ground-fault circuit-interrupter (GFCI). Such a GFCI should be provided by the installer and should be tested on a routine basis. To test the GFCI, push the test button. The GFCI should interrupt power. Push reset button. Power should be restored. If the GFCI fails to operate in this manner, the GFCI is defective. If the GFCI interrupts power to the electrical equipment without the test button being pushed, a ground current is flowing, indicating the possibility of an electrical shock. Do not use this electrical equipment. Disconnect the electrical equipment and have the problem corrected by a qualified service representative before using.

⚠ CAUTION – HAYWARD® pumps are intended for use with permanently-installed pools and may be used with hot tubs and spas if so marked. Do not use with storable pools. A permanently-installed pool is constructed in or on the ground or in a building such that it cannot be readily disassembled for storage. A storable pool is constructed so that it is capable of being readily disassembled for storage and reassembled to its original integrity.

SAVE THESE INSTRUCTIONS



HAYWARD®

HAYWARD® Pool Products Limited Warranty

To original purchasers of this equipment, Hayward Industries, Inc. warrants its Saline C 6.0 Junction Box HCSJBOX-BU to be free from defects in materials and workmanship for a period of One (1) year.

The limited warranty excludes damage from freezing, negligence, improper installation, improper use or care or any Acts of God. Parts that fail or become defective during the warranty period shall be repaired or replaced, at our option, within 90 days of the receipt of defective product, barring unforeseen delays, without charge.

Proof of purchase is required for warranty service. In the event proof of purchase is not available, the manufacturing date of the product will be the sole determination of the purchase date.

To obtain warranty service, please contact the place of purchase or the nearest Hayward Authorized Service Center. For assistance on your nearest Hayward Authorized Service Center please visit us at www.haywardpool.com.

Hayward shall not be responsible for cartage, removal, repair or installation labor or any other such costs incurred in obtaining warranty replacements or repair.

The Hayward Pool products warranty does not apply to components manufactured by others. For such products, the warranty established by the respective manufacturer will apply.

The express limited warranty above constitutes the entire warranty of Hayward Pool Products with respect to its pool products and is in lieu of all other warranties expressed or implied, including warranties of merchantability or fitness for a particular purpose. In no event shall Hayward Pool products be responsible for any consequential, special or incidental damages of any nature.

Some states do not allow a limitation on how long an implied warranty lasts, or the exclusion of incidental or consequential damages, so the above limitation may not apply to you. This warranty gives you specific legal rights, and you may also have other rights, which vary from state to state.

Hayward Pool Products
620 Division Street
Elizabeth, NJ 07207

*Supersedes all previous publications.



Product Registration

(Retain For Your Records)

DATE OF INSTALLATION _____

Retain Warranty in a safe and convenient location for you records.

DETACH HERE: Fill out bottom portion completely and mail within 10 days of purchase/installation or register online



SALINE C 6.0 Junction Box

Warranty Card Registration

First Name _____ Last Name _____

Street Address _____

City _____ State _____ Zip _____

Phone Number _____ Purchase Date _____

E-mail Address _____

Serial Number (may not be applicable)

--	--	--	--	--	--	--	--	--	--	--	--	--	--	--	--	--	--	--	--

Model Number _____

Pool Capacity (US gallons) _____

Please include me on all e-mail communications regarding Hayward® Equipment or promotions.

Mail to: Hayward Pool Products, 620 Division Street, Elizabeth, NJ 07207

Attn: Warranty Dept or REGISTER YOUR WARRANTY ON-LINE AT www.haywardcommercialpool.com.



HAYWARD®

FOR FURTHER INFORMATION OR CONSUMER
TECHNICAL SUPPORT, VISIT OUR WEBSITE AT
www.haywardcommercialpool.com



Hayward is a registered trademark and Saline C is a trademark of Hayward Industries, Inc. © 2013 Hayward Industries, Inc.

All other trademarks not owned by Hayward are the property of their respective owners. Hayward is not in any way affiliated with or endorsed by those third parties.