

COMMERCIAL SERIES LIFTS RETRO-FIT ANCHORING SYSTEM INSTALLATION MANUAL



RETRO-FIT/COMMERCIAL SERIES

RETRO-FIT ANCHORING SYSTEM COMMERCIAL SERIES LIFTS

PACKING LIST

- 3 – Threaded Anchor's with base
- 3 – $\frac{3}{4}$ " Nuts
- 3 – $\frac{3}{4}$ "x 1" Bolts
- 1 – T – Shaped Template



RETRO-FIT/COMMERCIAL SERIES

ADA GUIDELINES FOR POOL LIFT PLACEMENT

•Pool Lift Location. Pool lifts shall be located where the water level does not exceed 48 inches (1220 mm).

Seat Location. In the raised position, the centerline of the seat shall be located over the deck and 16 inches (405 mm) minimum from the edge of the pool. The deck surface between the centerline of the seat and the pool edge shall have a slope not steeper than 1:48.

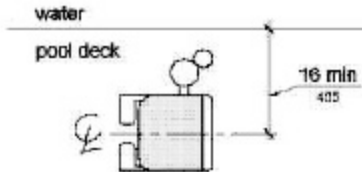

•Clear Deck Space. On the side of the seat opposite the water, a clear deck space shall be provided parallel with the seat.

The space shall be 36 inches (915 mm) wide minimum and shall extend forward 48 inches (1220 mm) minimum from a line located 12 inches (305 mm) behind the rear edge of the seat. The clear deck space shall have a slope not steeper than 1:48.

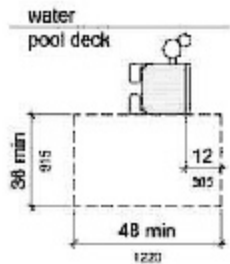

•Submerged Depth. The lift shall be designed so that the seat will submerge to a water depth of 18 inches (455 mm) minimum below the stationary water level. To make sure the lift has enough clearance the lift should be installed at a location with 44"-48" of Water depth

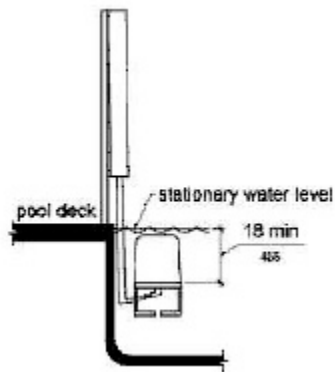

RETRO-FIT/COMMERCIAL SERIES



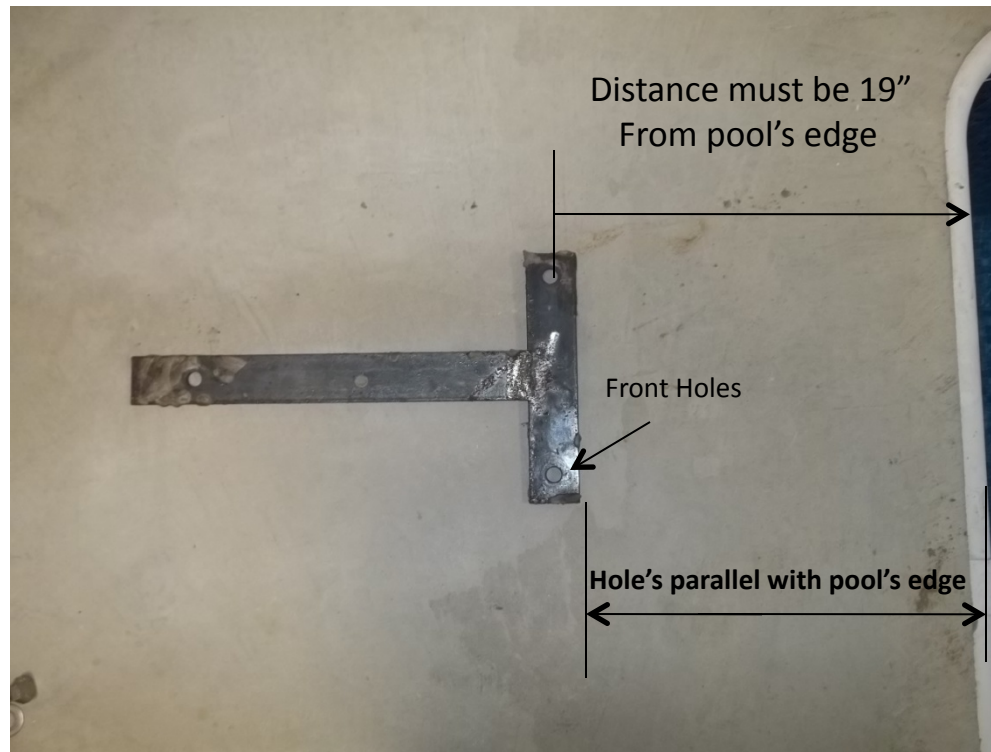

STEP 1: Locate the retro-fit anchoring system template (included and shown above)

- Once you determine where your lift is going to be located place the template down So you can mark on the concrete where you will need to drill the holes.
- The dimensions are as follows: The front holes (centerline) must be 19" From the pools edge. Also make sure that the front holes are parallel to the pools edge.



RETRO-FIT/COMMERCIAL SERIES

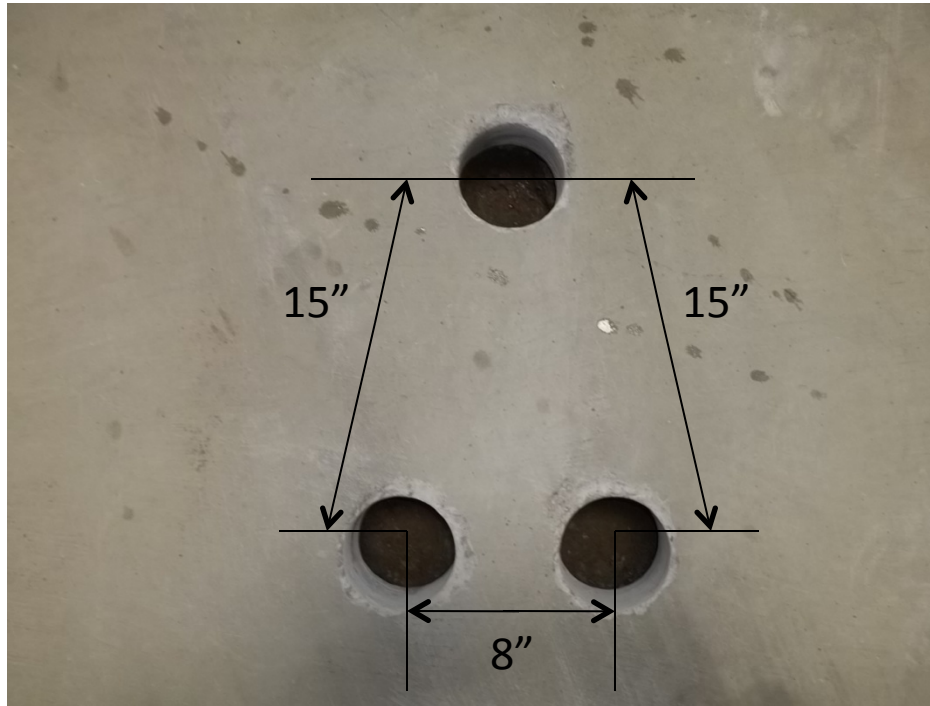

Step 2: You will need a 4" diameter core drilling bit.

- Make sure you have accurately marked your hole location to be drilled. After drilling Your holes they must be 6" deep and flat on the bottom of the hole (shown above). Also Double check your measurements they should be: Front holes 8" from centerline from hole to hole (see above). The measurement from front to back should be 15" from Centerline of each hole (see above)



RETRO-FIT/COMMERCIAL SERIES



Picture A



Picture B

Note: Anchor must be Electrically bonded. Please See the NEC requirements.

STEP 3: Assemble the template with the 3 threaded anchor rods.

- Place a $\frac{3}{4}$ " nut on top of each threaded rod, then place the template on top and bolt Down with the $\frac{3}{4}$ " bolts provided (refer to picture A).
- Place the assembly in your drilled holes as shown in picture B. make sure that the top Of the anchor rods are flush and level with the existing concrete, along with attaching The bonding wire that applies to local codes and ordinances.



RETRO-FIT/COMMERCIAL SERIES



Picture A



Picture B

STEP 4: Cementing the anchor in the concrete.

- You will need 20lbs of Quick dry Anchoring Cement (Commercial Grade Quikrete Exterior Use Anchoring Cement) to complete the installation. You can purchase at any hardware store in your area. Read the label and follow manufacturer's instructions.
- Start pouring into the 3 holes evenly until you fill them up, make sure not to overfill the Holes so that it does not create more work to scrap excess concrete off.
- Let the concrete set for 24hrs, Remove the template then sand the area with a sand stone to smooth the finish. Make sure the anchor's are flush with the concrete (picture B)
- You are now ready to install your Commercial Series lift.

