

STRAINER INLET FLANGE	ACRYLIC COVER OD	ACRYLIC COVER THICKNESS	QTY OF FASTENER SLOTS	FASTENER BOLT CIRCLE DIAMETER	FASTENER SLOT DISTANCE INSIDE	1/2" NPT VENT POSITION	STRAINER MFG DATE	GASKET TYPE	GASKET DIMENSIONS ID / OD (DASH NO)	ACRYLIC COVER PART NUMBER	GASKET PART NUMBER	Notes
Image Below	A	B	C	D								
3"	9.5"	1"	6	8.3125	7.8125	Center	1991 or after	Flat	5.75" /7.25"	1-030-5105A	1-030-5105D	Original SW
	10.25"	1"	6	8.875	8.375	Center	2009-2015	1/4" O-Ring	2-442 (7.25/7.75")	1-030-5105AN	1-030-5105O	INTERCHANGEABLE
	10.392"	1"	6	8.892	8.392	Side	2015 or after	1/4" O-Ring	-441 (7/7.5")	1-030-5105AN	1-030-5105ON	
4"	11.5"	1"	6	10.25	9.75	Center	1991 or after	Flat	7.5" /9.25"	1-040-5105A	1-040-5105D	Original SW
	12.375"	1"	6	11.25	10.75	Center	2009-2015	1/4" O-Ring	2-448 (9.5/10")	1-040-5105AC	1-040-5105O	SWC
	12.392"	1"	6	10.892	10.392	Side	2015 or after	1/4" O-Ring	-447 (9/9.5")	1-040-5105AN	1-040-5105ON	NEW SW
6"	13.625"	1"	6	12.4375	11.9375	Center	1991 or after	Flat	9.25" /11.75"	1-060-5105A	1-060-5105D	Original SW
	14.75"	1"	6	13.5	13	Center	2009-2015	1/4" O-Ring	2-452 (11.5/12")	1-060-5105AC	1-060-5105O	SWC
	14.517"	1"	6	13.017	12.517	Side	2015 or after	1/4" O-Ring	-451 (11/11.5")	1-060-5105AN	1-060-5105ON	NEW SW
8"	15.625"	1"	6	14.4375	13.9375	Center	1991 or after	Flat	11" /13.5"	1-080-5105A	1-080-5105D	Original SW
	16.867"	1"	6	15.6	15.1	Center	2009-2015	1/4" O-Ring	2-456 (13.5/14")	1-100-5105A	1-080-5105O	SWC (uses 10" Original SW)
	16.517"	1"	6	15.017	14.517	Side	2015 or after	1/4" O-Ring	-455 (13/13.5")	1-080-5105AN	1-060-5105ON	NEW SW
10"	16.867"	1"	6	15.6	15.1	Center	1991 or after	Flat	12.25" /15"	1-100-5105A	1-100-5105D	Original SW
	19"	1.25"	8	17.75	17.25	Center	2009-2015	1/4" O-Ring	2-459 (15/15.5")	1-120-5105A	1-100-5105O	SWC (uses 12" Original SW)
	18.017"	1"	6	16.517	16.017	Side	2015 or after	1/4" O-Ring	-458 (14.5/15")	1-100-5105AN	1-060-5105ON	NEW SW
12"	19"	1.25"	8	17.75	17.25	Center	1991 or after	Flat	14.75" /16.75"	1-120-5105A	1-120-5105D	Original SW
	20.875"	1.5"	12	19.75	19.25	Center	2009-2015	1/4" O-Ring	2-464 (17.5/18")	1-140-5105A	1-120-5105O	SWC (uses 14" Original SW)
	20.017"	1.25"	8	18.517	18.017	Side	2015 or after	1/4" O-Ring	-462 (16.5/17")	1-100-5105AN	1-060-5105ON	NEW SW
14"	20.875	1.5"	12	19.75	19.25	Center	1991 or after	Flat	16.75" /18.75"	1-140-5105A	1-140-5105D	Original SW
	22.75"	1.5"	12	21.68	21.18	Center	2009-2015	1/4" O-Ring	2-467 (19-19.5")	1-160-5105A	1-140-5105O	SWC (uses 16" Original SW)
	20.017"	1.25"	12	20.767	20.267	Side	2015 or after	1/4" O-Ring	-466 (18.5-19")	1-100-5105AN	1-060-5105ON	NEW SW

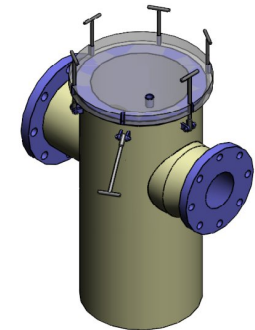
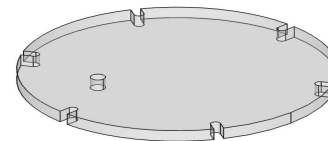
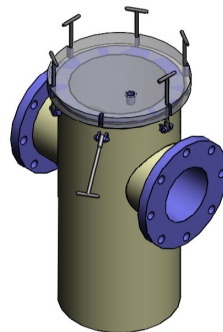
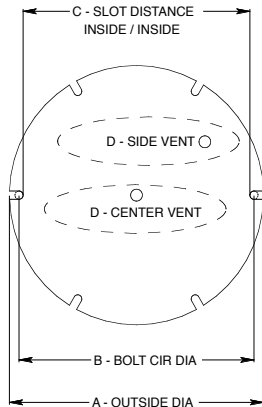

SWX SERIES- REPLACEMENT COVER AND GASKETS

LOW PROFILE STRAINERS FOR OLD MARLOW C10X AND D10X STRAINERS

STRAINER INLET FLANGE	ACRYLIC COVER OD	ACRYLIC COVER THICKNESS	QTY OF FASTENER SLOTS	FASTENER BOLT CIRCLE DIAMETER	FASTENER SLOT DISTANCE INSIDE	1/2" NPT VENT POSITION	STRAINER MFG DATE	GASKET TYPE	GASKET DIMENSIONS ID / OD (DASH NO)	ACRYLIC COVER PART NUMBER	GASKET PART NUMBER
Image Below	A			B	C	D					
ALL SWX SIZES	13.625" 14.517"	1" 1"	6 6	12.4375 13.017	11.9375 12.517	Center Side	1991 or after 2015 or after	Flat 1/4" O-Ring	9.25" / 11.75" -451 (11/11.5")	1-060-5105A 1-060-5105AN	1-060-5105D 1-060-5105ON

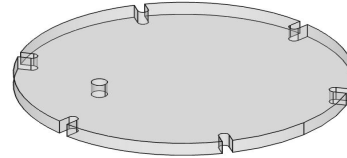
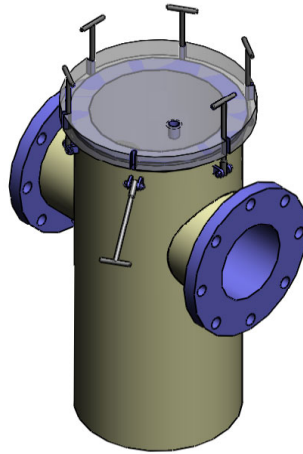
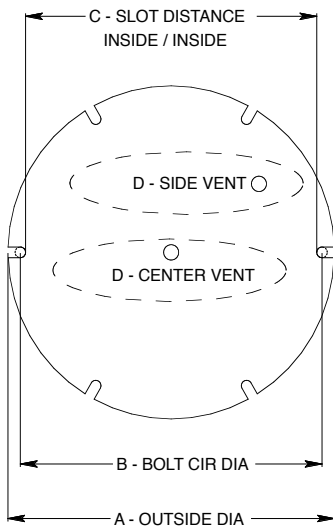

NOTE- ALL SWX SERIES STRAINERS HAVE THE SAME SIZE HOUSING, COVER AND GASKET

FLUIDTROL PROCESS TECHNOLOGIES, INC.
 3460 STANWOOD BLVD
 HUNTSVILLE, AL 35811
WWW.FLUIDTROL.COM
 888-551-0511

