

FLOWSTAR® CHECK VALVE, 2-WAY, 2" SOCKET X 2.5" SPIGOT



Durable and dependable check valves



FEATURES

- Made from durable CPVC
- Minimal hydraulic loss
- Clear lid for easy inspection
- Easy to disassemble when clearing debris
- Corrosion resistant stainless steel swing
- Highly resistant to chlorine
- 12 per case

NEW



Part # AVC20C

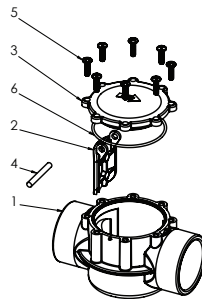

1. 2-Way, 2" Soc. x 2.5" Spg. Valve
2. Flapper Assembly
3. Cover
4. Pin
5. #.25 x 3/4" Lg. Pan Head Phillips, Type A Screw, 316SS, Qty 8
6. O-Ring, #152, EPDM

